

Map Series Information:

These plans show the land potentially required during construction, the construction features, access requirements and infrastructure associated with construction of the Proposed Scheme. The plans also show the construction phase arrangements for public access using Public Rights of Way.

The base mapping shown on the plans is reflective of 2020 Ordnance Survey (OS) data.

- Main Map Legend**
- Route in tunnel
 - Route on surface
 - Depot, station, headhouse or portal building
 - Community area boundary
 - Existing railway station
 - County boundary
 - District/Borough boundary
 - Map sheets included in this community area
 - Map sheets not included in this community area

Map Number CT-05-INDEX-MA02

Map Name
Index Map of:
Construction Phase

Community Area MA02:
Wimboldsley to Lostock Gralam

HS2

Registered in England, Registration number: 06791686.
Registered office: 2, Snowhill, Quersway,
Birmingham B4 6GA.

© Crown copyright and database rights 2020
OS 100049190

Doc Number: 2DE01-MWJ-EV-MAP-M000-000002-P07

Date: 20/10/21

Scale at A3: 1:75,000

0 750 1,500 2,250 3,000
Metres

HS2 Ltd accept no responsibility for any circumstances, which arise from the reproduction of this map after alteration, amendment or abbreviation or if it is issued in part or issued incomplete in any way.

North arrow

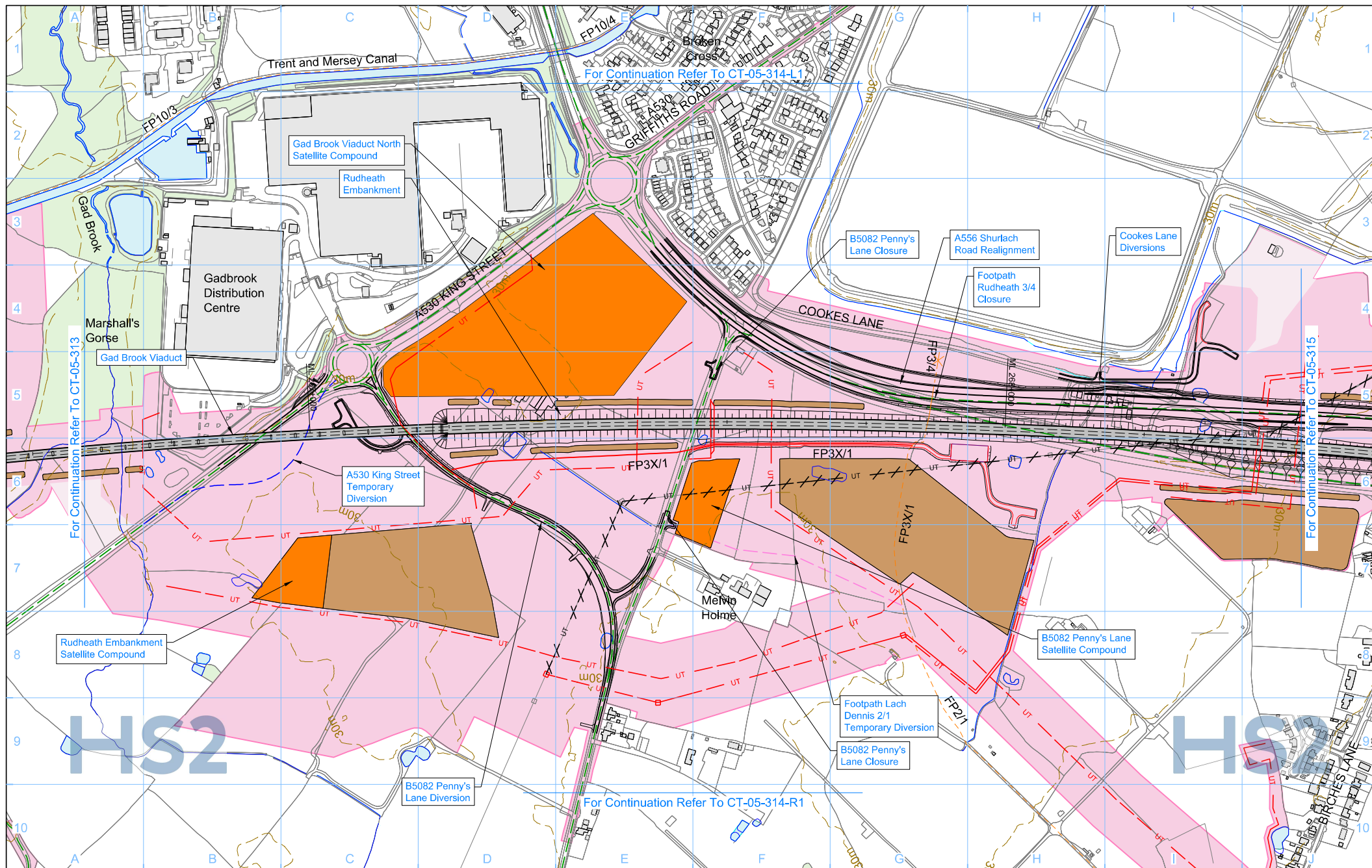

<p>Legend</p> <ul style="list-style-type: none"> Depot, station, headhouse or portal building Tunnel portal Main construction compounds Satellite construction compounds Railway systems compounds System railheads Temporary material stockpile 	<ul style="list-style-type: none"> Borrow pit Railway systems site Storage / prefabrication / laydown areas Land potentially required during construction Land potentially required for mitigation planting Temporary replacement community facility Rail alignment formation Temporary workers accommodation 	<ul style="list-style-type: none"> Community area boundary Construction traffic route Existing public right of way Land potentially required during construction Temporary public right of way closure Temporary public right of way diversion / realignment New, diverted or realigned public right of way 	<ul style="list-style-type: none"> Landscape earthworks Engineering earthworks Temporary highway diversion / realignment Major utility works Major utility works - Removed County boundary Borough / District boundary Tunnels external extent 	<ul style="list-style-type: none"> Existing woodland Existing buildings Existing inland water Existing contours Existing watercourse HS2 access Rail alignment Chainage (e.g. 10+000) 	<p>Map Number CT-05-314</p> <p>Map Name Construction Phase</p> <p>Community Area MA02 Wimboldsey to Lostock Gralam</p>	<p>HS2</p> <p>Registered in England Registration No. 06791886 Registered office: 2 Silver Hill, Queensway, Birmingham, B4 6GA</p> <p>HS2 Ltd accept no responsibility for any circumstances, which arise from the reproduction of this map after alteration, amendment or abbreviation or if it is issued in part or issued incomplete in any way.</p> <p>Scale at A3: 1:5,000</p> <p>0 50 100 150 200 250 Metres</p> <p>© Crown copyright and database rights 2020. Ordnance Survey Licence Number: 100049190.</p> <p>Doc Number: 2DE01-MWJ-EV-DPL-M002-500314 P10 Date: 10/08/21</p>
------------------------------------------------------------------------------------------------------------------------------------------------------------------------------------------------------------------------------------------------------------------------------------------------------------------------------	---------------------------------------------------------------------------------------------------------------------------------------------------------------------------------------------------------------------------------------------------------------------------------------------------------------------------------------------------------------------------------------------	----------------------------------------------------------------------------------------------------------------------------------------------------------------------------------------------------------------------------------------------------------------------------------------------------------------------------------------------------------------------------------	------------------------------------------------------------------------------------------------------------------------------------------------------------------------------------------------------------------------------------------------------------------------------------------------------------------------------	------------------------------------------------------------------------------------------------------------------------------------------------------------------------------------------------------------------------------------------------------------	--------------------------------------------------------------------------------------------------------------------------------------------------	-------------------------------------------------------------------------------------------------------------------------------------------------------------------------------------------------------------------------------------------------------------------------------------------------------------------------------------------------------------------------------------------------------------------------------------------------------------------------------------------------------------------------------------------------------------------------------------------------------------------

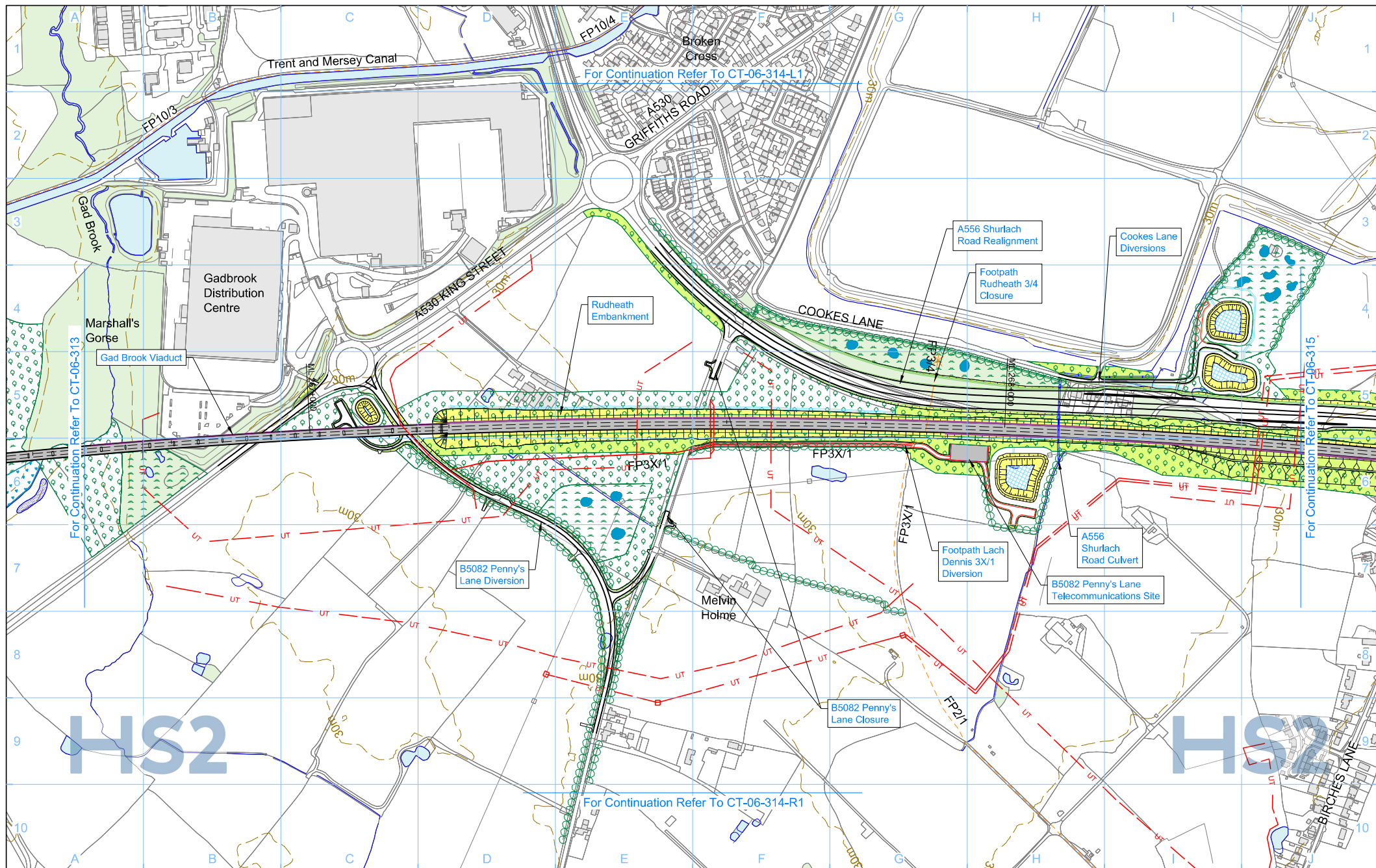

Legend			
Depot, station, headhouse or portal building	Pumping station	Local placement	Engineering earthworks
Tunnel portal	Woodland habitat creation	Returned to suitable development use	Landscape earthworks
Railway Systems Site	Wetland habitat creation	Hedgerow	Rail alignment formation
Ecological mitigation pond (indicative only)	Grassland habitat creation	County boundary	Tunnels external extent
Balancing pond	Landscape mitigation planting (scrub / woodland)	Borough / District boundary	Major utility works
Replacement floodplain storage area	Grassed areas	Community area boundary	Existing public right of way
	Public realm	Watercourse diversion	New, diverted or realigned public right of way
	Replacement Community Facility	Existing watercourse	Public right of way closure
		New ditches	
			Existing woodland
			Existing buildings
			Existing inland water
			Existing contours
			HS2 access
			Noise fence barrier
			Rail alignment
			Chainage (e.g. 10+000)

Map Information	
Map Number	CT-06-314
Map Name	Proposed Scheme
Community Area	MA02 Wimbolsley to Lostock Gt

HS2 Ltd accept no responsibility for any circumstances, which arise from the reproduction of this map after alteration, amendment or abbreviation or if it is issued in part or issued incomplete in any way.

Registered in England
Registration No. 06791886
Registered office:
2 Silver Hill, Queensway,
Birmingham, B4 6GA

© Crown copyright and database rights 2020.
Ordnance Survey Licence Number: 100049190.

Doc Number: 2DE01-MWJ-EV-DPL-M002-600314 P09 Date: 10/08/21

Scale at A3: 1:5,000

0 50 100 150 200 250 Metres

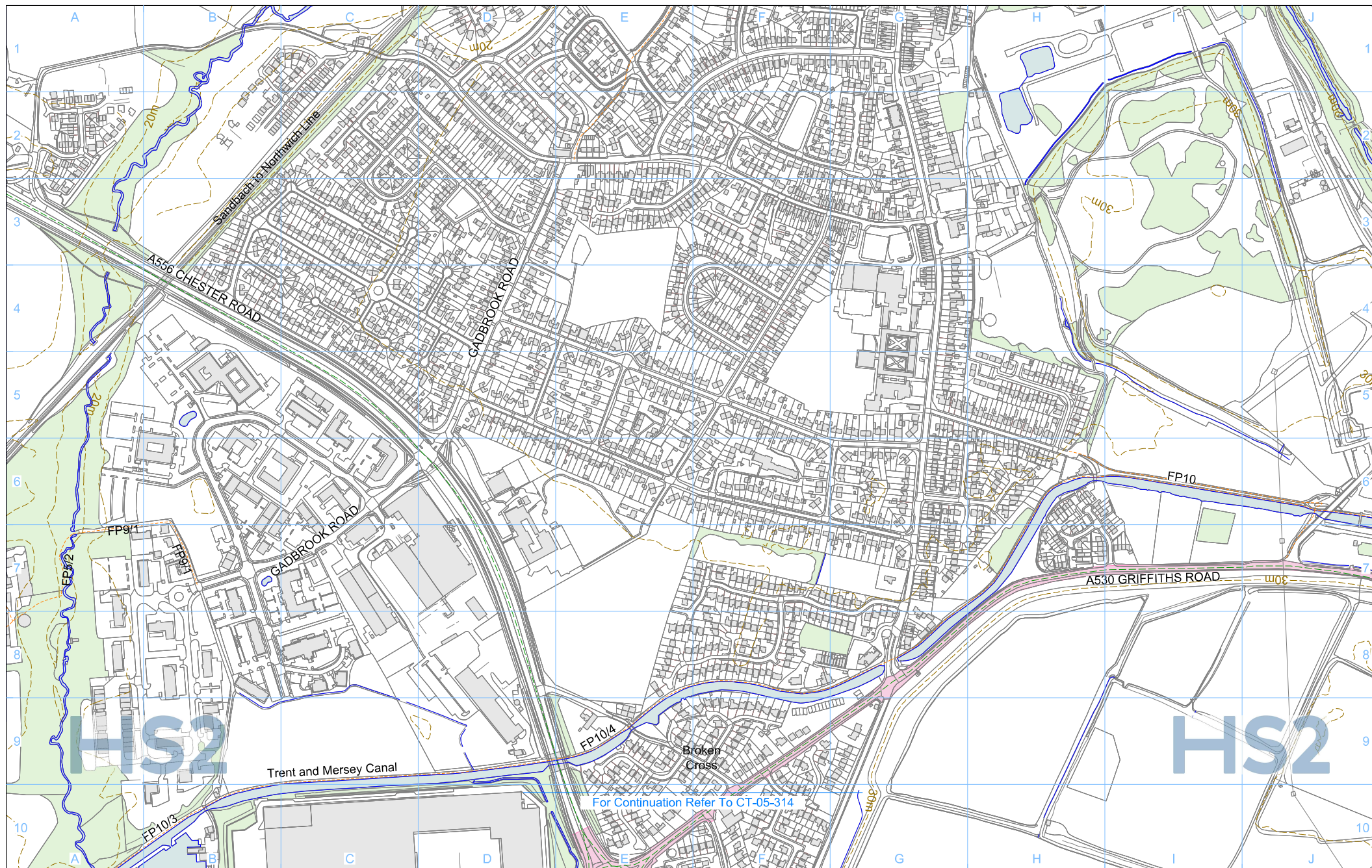

Legend	
Depot, station, headhouse or portal building	Borrow pit
Tunnel portal	Railway systems site
Main construction compounds	Storage / prefabrication / laydown areas
Satellite construction compounds	Land potentially required during construction
Railway systems compounds	Land potentially required for mitigation planting
System railheads	Temporary replacement community facility
Temporary material stockpile	Rail alignment formation
	Temporary workers accommodation
Community area boundary	Construction traffic route
Existing public right of way	Public right of way closure
Temporary public right of way closure	Temporary public right of way diversion / realignment
New, diverted or realigned public right of way	Landscape earthworks
Engineering earthworks	Temporary highway diversion / realignment
Major utility works	Major utility works - Removed
County boundary	Borough / District boundary
Tunnels external extent	Existing woodland
	Existing buildings
	Existing inland water
	Existing contours
	Existing watercourse
	HS2 access
	Rail alignment Chainage (e.g. 10+000)

Map Number
CT-05-314-L1

Map Name
Construction Phase

Community Area
MA02 Wimbodley to Lostock Gt

HS2

Registered in England
Registration No. 06791686
Registered office:
2 Silver Hill, Quakersway,
Birmingham, B4 6GA

Scale at A3: 1:5,000

0 50 100 150 200 250
Metres

© Crown copyright and database rights 2020.
Ordnance Survey Licence Number: 100049190.

Doc Number: 2DE01-MWJ-EV-DPL-M002-501314

P04 Date: 25/06/21

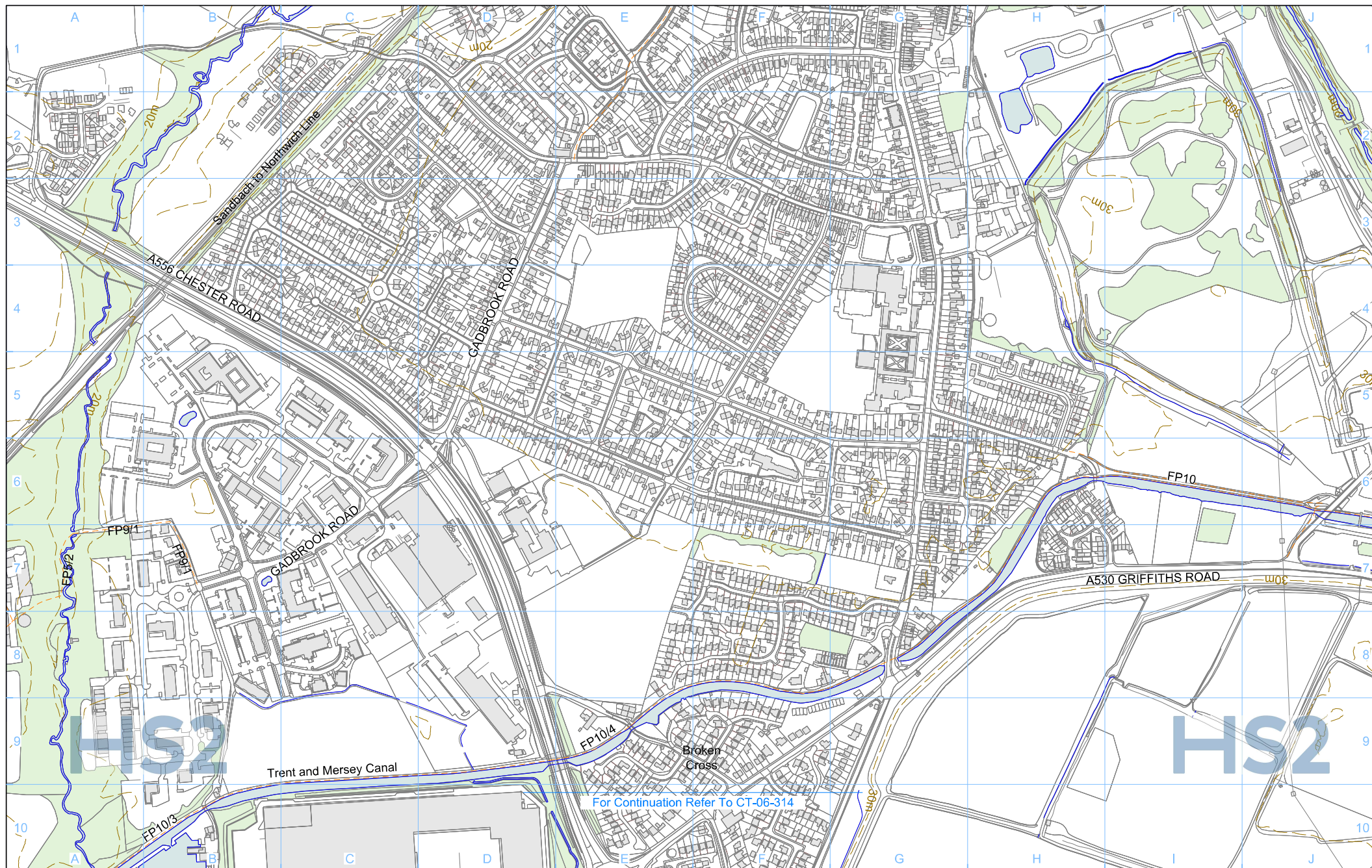

Legend	<ul style="list-style-type: none">Depot, station, headhouse or portal buildingTunnel portalRailway Systems SiteEcological mitigation pond (Indicative only)Balancing pondReplacement floodplain storage area	<ul style="list-style-type: none">Pumping stationWoodland habitat creationWetland habitat creationGrassland habitat creationLandscape mitigation planting (scrub / woodland)Grassed areasPublic realmReplacement Community Facility	<ul style="list-style-type: none">Local placementReturned to suitable development useHedgerowCounty boundaryBorough / District boundaryCommunity area boundaryWatercourse diversionExisting watercourseNew ditches	<ul style="list-style-type: none">Engineering earthworksLandscape earthworksRail alignment formationTunnels external extentMajor utility worksExisting public right of wayNew, diverted or realigned public right of wayPublic right of way closure	<ul style="list-style-type: none">Existing woodlandExisting buildingsExisting inland waterExisting contoursHS2 accessNoise fence barrierRail alignmentChainage (e.g. 10+000)
---------------	-------------------------------------------------------------------------------------------------------------------------------------------------------------------------------------------------------------------------------------------------------------------------	------------------------------------------------------------------------------------------------------------------------------------------------------------------------------------------------------------------------------------------------------------------------------------------------------------------	----------------------------------------------------------------------------------------------------------------------------------------------------------------------------------------------------------------------------------------------------------------------------------------------------------	----------------------------------------------------------------------------------------------------------------------------------------------------------------------------------------------------------------------------------------------------------------------------------------------------------------------------------	-----------------------------------------------------------------------------------------------------------------------------------------------------------------------------------------------------------------------------------------------------------

Map Number: **CT-06-314-L1**

Map Name: **Proposed Scheme**

Community Area: **MA02 Wimboldsley to Lostock Gtalam**

HS2

Registered in England
Registration No. 06791886
Registered office:
2 Silver Hill, Quensway,
Birmingham, B4 6GA

Scale at A3: 1:5,000

0 50 100 150 200 250
Metres

© Crown copyright and database rights 2020.
Ordnance Survey Licence Number: 100049190.

Doc Number: 2DE01-MWJ-EV-DPL-M002-601314 P04 Date: 25/06/21

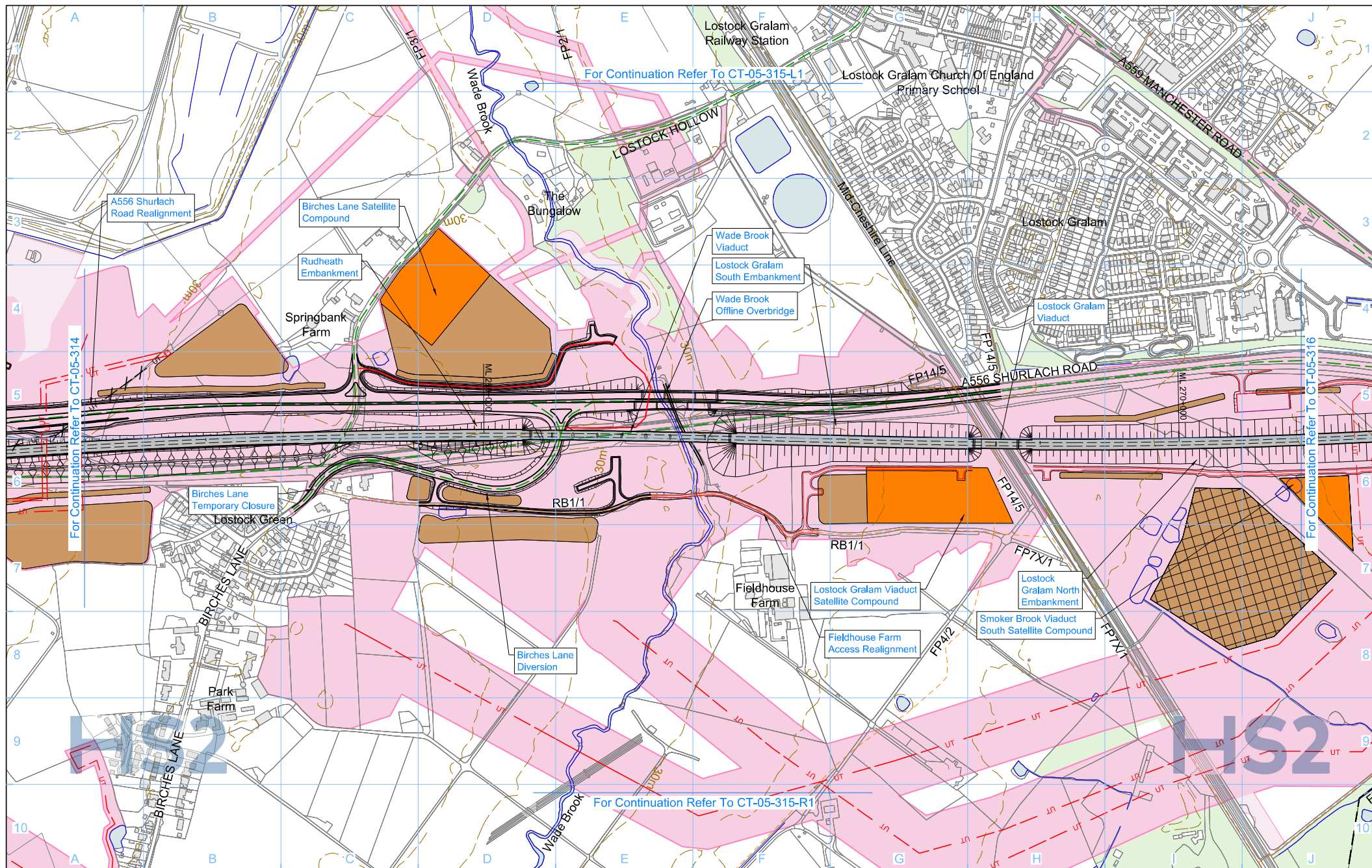

<p>Legend</p> <ul style="list-style-type: none"> Depot, station, headhouse or portal building Tunnel portal Main construction compounds Satellite construction compounds Railway systems compounds System railheads Temporary material stockpile 	<ul style="list-style-type: none"> Borrow pit Railway systems site Storage / prefabrication / laydown areas Land potentially required during construction Land potentially required for mitigation planting Temporary replacement community facility Rail alignment formation Temporary workers accommodation 	<ul style="list-style-type: none"> Community area boundary Construction traffic route Existing public right of way Public right of way closure Temporary public right of way closure Temporary public right of way diversion / realignment New, diverted or realigned public right of way 	<ul style="list-style-type: none"> Landscape earthworks Engineering earthworks Temporary highway diversion / realignment Major utility works Major utility works - Removed County boundary Borough / District boundary Tunnels external extent 	<ul style="list-style-type: none"> Existing woodland Existing buildings Existing inland water Existing contours Existing watercourse HS2 access Rail alignment Chainage (e.g. 10+000) 	<p>Map Number CT-05-315</p> <p>Map Name Construction Phase</p> <p>Community Area MA02 Wimboldsley to Lostock Garam</p>	<p>HS2</p> <p>Registered in England Registration No. 06791866 Registered office: 2 Snow Hill, Queensway, Birmingham, B4 6GA</p> <p>HS2 Ltd accept no responsibility for any circumstances, which arise from the reproduction of this map after alteration, amendment or abbreviation or if it is issued in part or issued incomplete in any way.</p> <p>Scale at A3: 1:5,000</p> <p>0 50 100 150 200 250 Metres</p> <p>© Crown copyright and database rights 2020, Ordnance Survey Licence Number: 100049190.</p> <p>Doc Number: 2DE01-MWJ-EV-DPL-M002-500315 P09 Date: 10/08/21</p>
------------------------------------------------------------------------------------------------------------------------------------------------------------------------------------------------------------------------------------------------------------------------------------------------------------------------------	---------------------------------------------------------------------------------------------------------------------------------------------------------------------------------------------------------------------------------------------------------------------------------------------------------------------------------------------------------------------------------------------	----------------------------------------------------------------------------------------------------------------------------------------------------------------------------------------------------------------------------------------------------------------------------------------------------------------------------------------------------------------	------------------------------------------------------------------------------------------------------------------------------------------------------------------------------------------------------------------------------------------------------------------------------------------------------------------------------	------------------------------------------------------------------------------------------------------------------------------------------------------------------------------------------------------------------------------------------------------------	--------------------------------------------------------------------------------------------------------------------------------------------------	---------------------------------------------------------------------------------------------------------------------------------------------------------------------------------------------------------------------------------------------------------------------------------------------------------------------------------------------------------------------------------------------------------------------------------------------------------------------------------------------------------------------------------------------------------------------------------------------------------------------

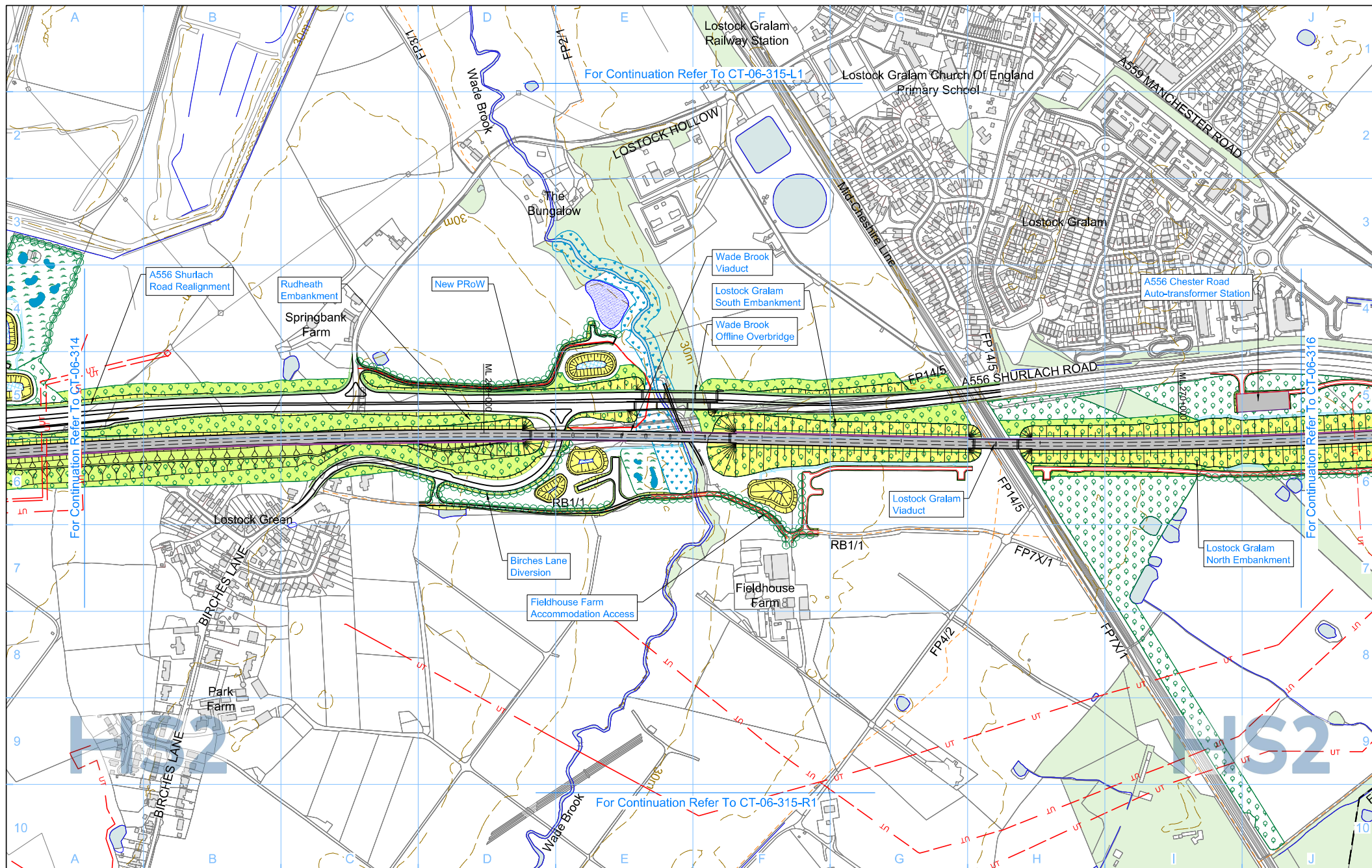

Legend <ul style="list-style-type: none">Depot, station, headhouse or portal buildingTunnel portalRailway Systems SiteEcological mitigation pond (Indicative only)Balancing pondReplacement floodplain storage area	<ul style="list-style-type: none">Pumping stationWoodland habitat creationWetland habitat creationGrassland habitat creationLandscape mitigation planting (scrub / woodland)Grassed areasPublic realmReplacement Community Facility	<ul style="list-style-type: none">Local placementReturned to suitable development useHedgerowCounty boundaryBorough / District boundaryCommunity area boundaryWatercourse diversionNew, diverted or realigned public right of wayPublic right of way closure	<ul style="list-style-type: none">Engineering earthworksLandscape earthworksRail alignment formationTunnels external extentMajor utility worksExisting public right of wayNew, diverted or realigned public right of wayPublic right of way closure	<ul style="list-style-type: none">Existing woodlandExisting buildingsExisting inland waterExisting contoursHS2 accessNoise fence barrierRail alignmentChainage (e.g. 10+000)	<p>Map Number CT-06-315</p> <p>Map Name Proposed Scheme</p> <p>Community Area MA02 Wimboldsley to Lostock Gt. Garam</p>	<p>HS2</p> <p>Registered in England Registration No. 06791886 Registered office: 2 Snow Hill, Queensway, Birmingham, B4 6QA</p> <p>Scale at A3: 1:5,000</p> <p>0 50 100 150 200 250 Metres</p> <p>© Crown copyright and database rights 2020. Ordnance Survey Licence Number: 100049190.</p> <p>Doc Number: 2DE01-MWJ-EV-DPL-M002-600315 P09 Date: 10/08/21</p>
------------------------------------------------------------------------------------------------------------------------------------------------------------------------------------------------------------------------------------------------------------------------------------------	------------------------------------------------------------------------------------------------------------------------------------------------------------------------------------------------------------------------------------------------------------------------------------------------------------------	----------------------------------------------------------------------------------------------------------------------------------------------------------------------------------------------------------------------------------------------------------------------------------------------------------------------------------------------------	----------------------------------------------------------------------------------------------------------------------------------------------------------------------------------------------------------------------------------------------------------------------------------------------------------------------------------	-----------------------------------------------------------------------------------------------------------------------------------------------------------------------------------------------------------------------------------------------------------	---------------------------------------------------------------------------------------------------------------------------------------------------	------------------------------------------------------------------------------------------------------------------------------------------------------------------------------------------------------------------------------------------------------------------------------------------------------------------------------------------------------------------------------------------------

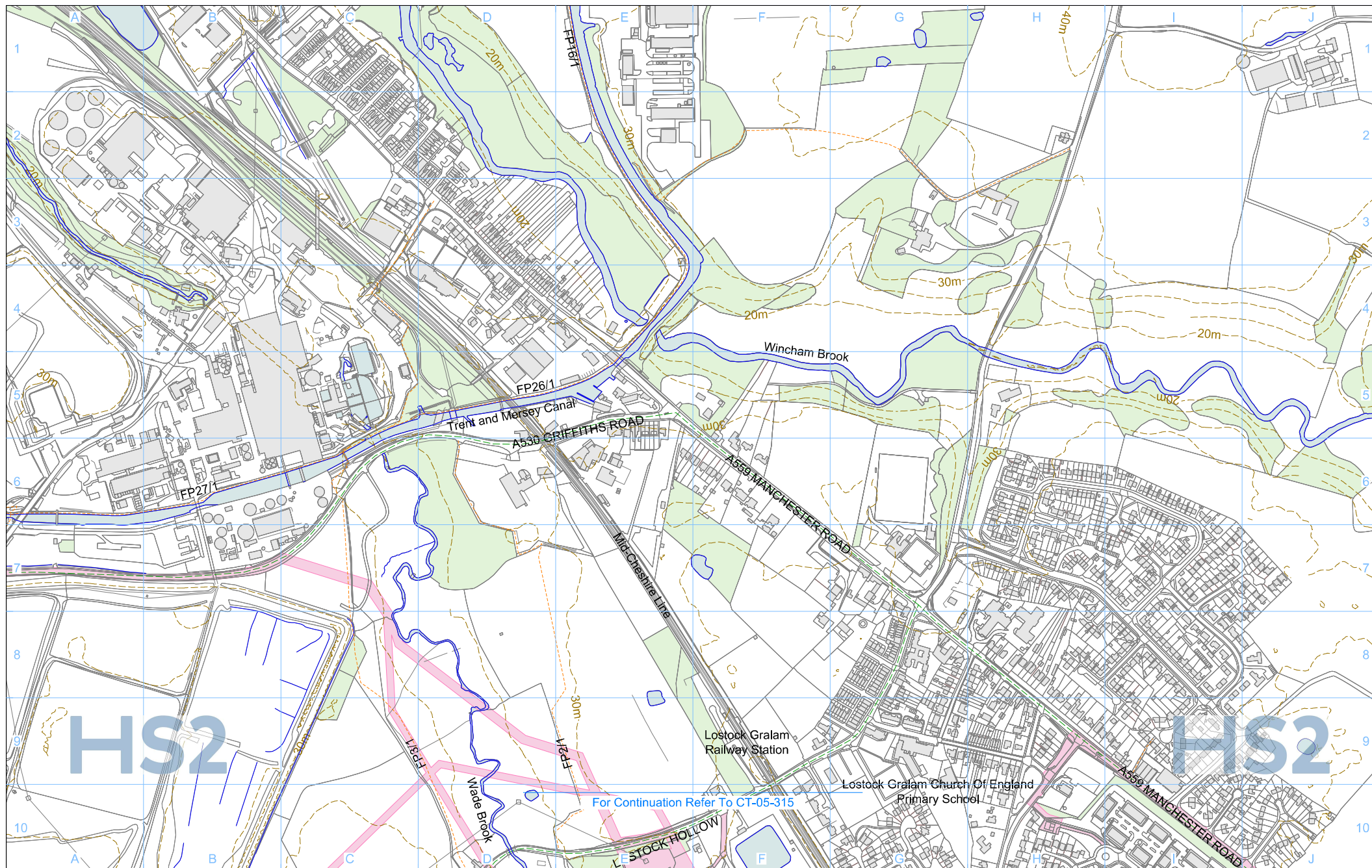

Legend

Map Number

CT-05-315-L1

Map Name

Construction Phase

Community Area

MA02 Wimboldsley to Lostock Gralam

HS2

Registered in England
Registration No. 06791866
Registered Office:
2 Silver Hill, Queensway,
Birmingham, B4 6GA

© Crown copyright and database rights 2020,
Ordnance Survey Licence Number: 100049190.

Doc Number: 2DE01-MWJ-EV-DPL-M002-501315

HS2 Ltd accept no responsibility for any circumstances, which arise from the reproduction of this map after alteration, amendment or abbreviation or if it is issued in part or issued incomplete in any way.

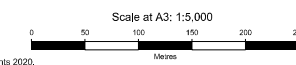

P04 Date: 25/06/21

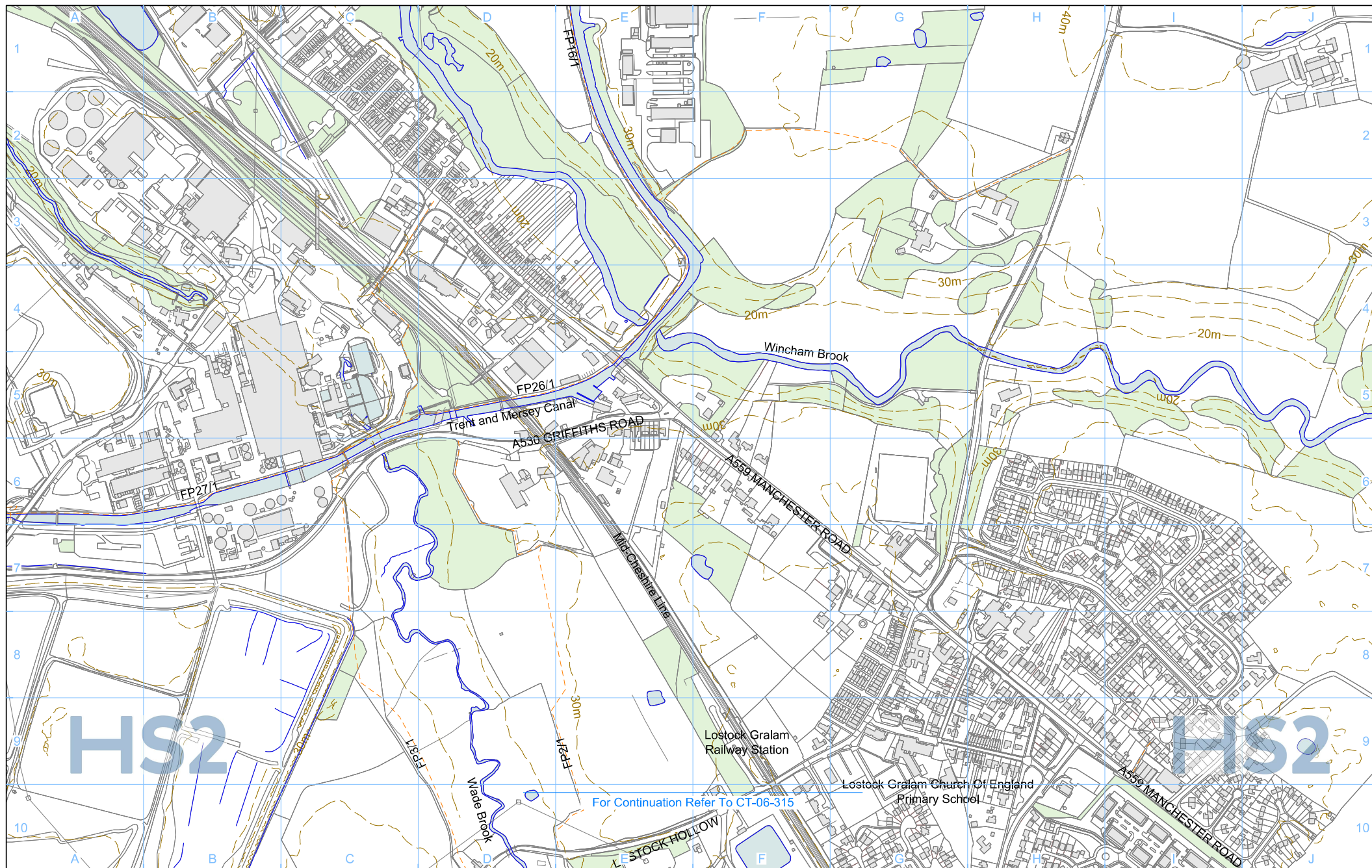

Legend			
	Depot, station, headhouse or portal building		Local placement
	Tunnel portal		Returned to suitable development use
	Railway Systems Site		Hedge row
	Ecological mitigation pond (Indicative only)		County boundary
	Replacement floodplain storage area		Borough / District boundary
	Pumping station		Community area boundary
	Woodland habitat creation		Watercourse diversion
	Wetland habitat creation		Existing watercourse
	Grassland habitat creation		New or
	Landscape mitigation planting (scrub / woodland)		Existing watercourse
	Grassed areas		New ditches
	Public realm		Engineering earthworks
	Replacement Community Facility		Landscape earthworks
			Rail alignment formation
			Tunnels external extent
			Major utility works
			Existing public right of way
			New, diverted or realigned public right of way
			Public right of way closure

Map Number	CT-06-315-L1
Map Name	Proposed Scheme
Community Area	MA02 Wimbodley to Lostock Groom

Registered in England
Registration No. 06791886
Registered office:
2 Silver Hill, Quensway,
Birmingham, B4 6GA

HS2 Ltd accept no responsibility for any circumstances, which arise from the reproduction of this map after alteration, amendment or abbreviation or if it is issued in part or issued incomplete in any way.

Scale at A3: 1:5,000

© Crown copyright and database rights 2020.
Ordnance Survey Licence Number: 100049190.

Doc Number: 2DE01-MWJ-EV-DPL-M002-601315 P04 Date: 25/06/21

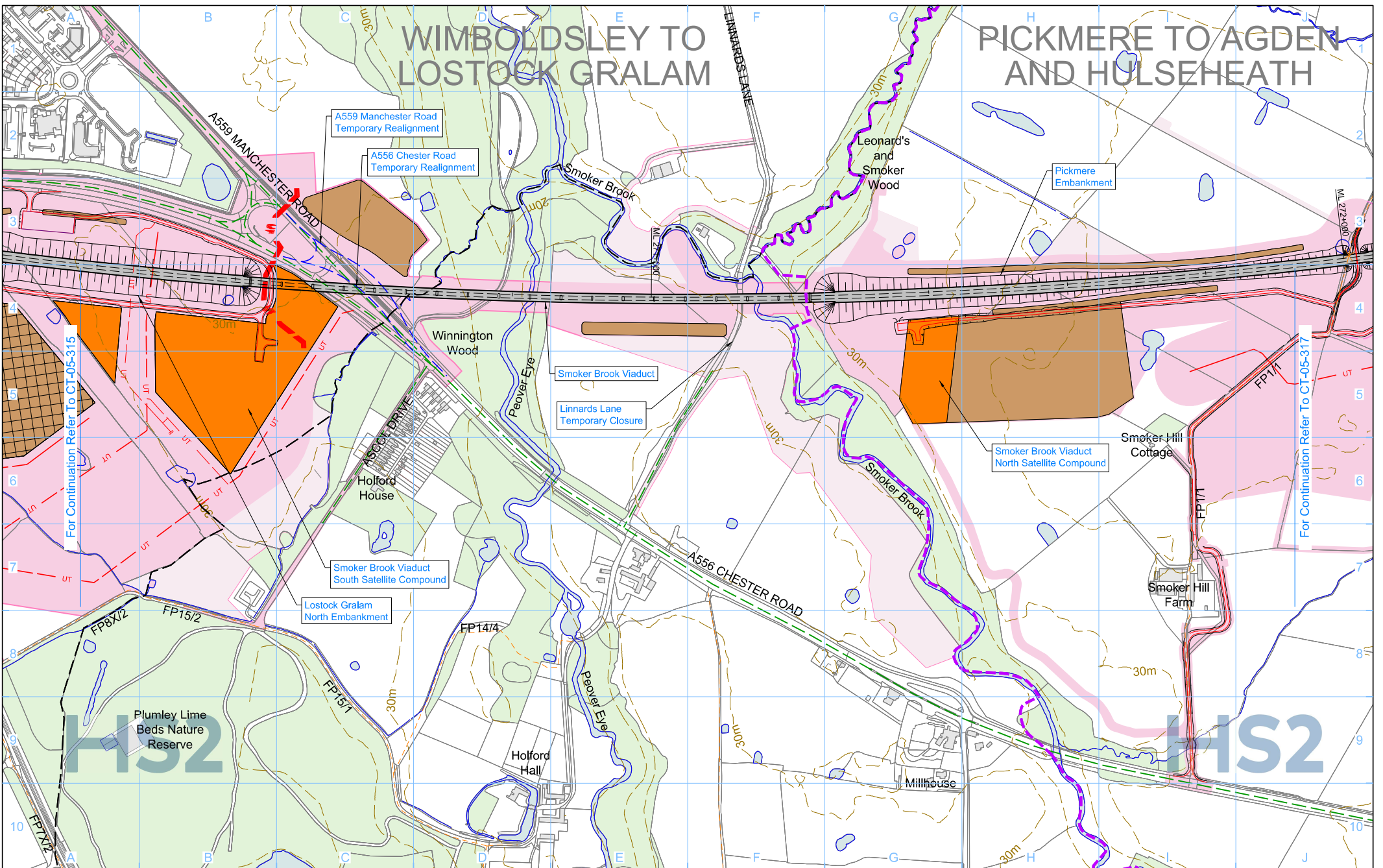

Legend			
	Depot, station, headhouse or portal building		Borrow pit
	Tunnel portal		Railway systems site
	Main construction compounds		Storage / prefabrication / laydown areas
	Satellite construction compounds		Land potentially required during construction
	Railway systems compounds		Land potentially required for mitigation planting
	System railheads		Temporary replacement community facility
	Temporary material stockpile		Rail alignment formation
			Temporary workers accommodation
			Community area boundary
			Construction traffic route
			Existing public right of way
			Public right of way closure
			Temporary public right of way closure
			Temporary public right of way diversion / realignment
			New, diverted or realigned public right of way
			Landscape earthworks
			Engineering earthworks
			Temporary highway diversion / realignment
			Major utility works
			Major utility works - Removed
			County boundary
			Borough / District boundary
			Tunnels external extent
			Existing woodland
			Existing buildings
			Existing inland water
			Existing contours
			Existing watercourse
			HS2 access
			Rail alignment Chainage (e.g. 10+000)

Map Number	CT-05-316a
Map Name	Construction Phase
Community Area	MA02 Wimboldsley to Lostock Gralam

HS2 Ltd accept no responsibility for any circumstances, which arise from the reproduction of this map after alteration, amendment or abbreviation or if it is issued in part or issued incomplete in any way.

Registered in England
Registration No. 06791866
Registered office:
2 Silver Hill, Queensway,
Birmingham, B4 6GA

© Crown copyright and database rights 2020,
Ordnance Survey Licence Number: 100049190.

Doc Number: 2DE01-MWJ-EV-DPL-M002-510316 P08 Date: 26/06/21

Scale at A3: 1:5,000

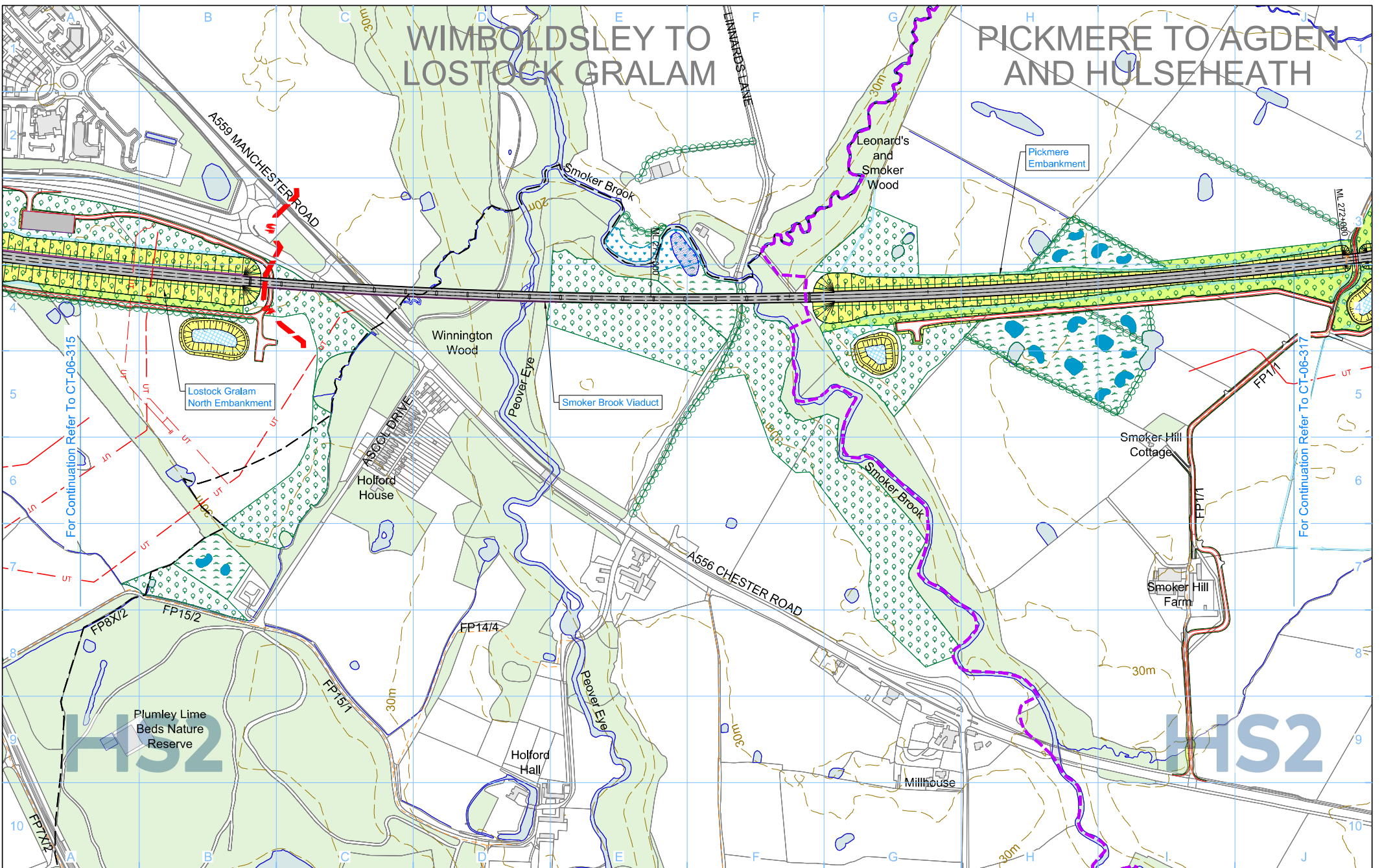

Legend			

Map Number
CT-06-316a

Map Name
Proposed Scheme

Community Area
MA02 Wimboldsley to LOSTOCK GRALAM

Map Number
CT-06-316a

Map Name
Proposed Scheme

Community Area
MA02 Wimboldsley to LOSTOCK GRALAM

HS2

Registered in England
Registration No: 06791886
Registered office:
2 Silver Hill, Queensway,
Birmingham, B4 6GA

© Crown copyright and database rights 2020,
Ordnance Survey Licence Number: 100049190.

Doc Number: 2DE01-MWJ-EV-DPL-M002-610316

P08 Date: 25/06/21

Scale at A3: 1:5,000

0 50 100 150 200 250
Metres