



**Freepost  
HAVE YOUR SAY**

### How can I have my say?

We want to get your feedback as we prepare the Section 36 variation application. Due to the restrictions of COVID-19 we are not able to hold a public event however there are a number of ways you can get involved in the consultation:

- > Fill in the questionnaire attached to this newsletter and pop it in the post
- > Take a look at our website [lostocksep.fccenvironment.co.uk](http://lostocksep.fccenvironment.co.uk) and fill in the online questionnaire
- > Attend our live webinar and Q&A on 11th February 2021 at 6pm.

### For further information or enquiries:

- > Email [LSEP@fontcomms.com](mailto:LSEP@fontcomms.com)
- > Call our information line **0800 689 1095**
- > Write to **Freepost HAVE YOUR SAY** (no stamp required)

Our consultation closes on 28th February 2021 so please send us your comments before then.

### Next steps

We expect to submit the variation application to the Department for Business, Energy and Industrial Strategy (BEIS) in summer 2021. Following this we will be writing to you again to set out how you can make your views known directly to BEIS. The application will also be posted on our website. We expect a decision from the Secretary of State for BEIS in spring 2022.

### About Us

LSEP is being delivered by LSEP Ltd, which is a joint venture between Copenhagen Infrastructure Partners (CIP) and FCC Environment.

Copenhagen Infrastructure Partners is one of the largest institutional investors in renewable energy in the world. It manages more than €8bn across six funds which have investments across a range of sustainable energy technologies including offshore wind, onshore wind, biomass, solar and energy from waste in multiple locations in Europe, North America and South East Asia. In the UK alone, CIP has investments in almost 1,000MW operating renewable capacity and 140MW of capacity under construction. CIP has offices in Copenhagen, New York, London, Sheffield, Utrecht, Hamburg and Taipei.

FCC will operate the facility. It is one of the UK's leading resource and waste management companies, employing over 2,400 people across the country. FCC's approach is to minimise the amount of waste that ends up in landfill by transforming it into valuable resources where possible. FCC recycles around 1.8 million tonnes of waste each year and generates more than 117MW of green energy.

[lostocksep.fccenvironment.co.uk](http://lostocksep.fccenvironment.co.uk)



## Energy from Waste Facility for Cheshire

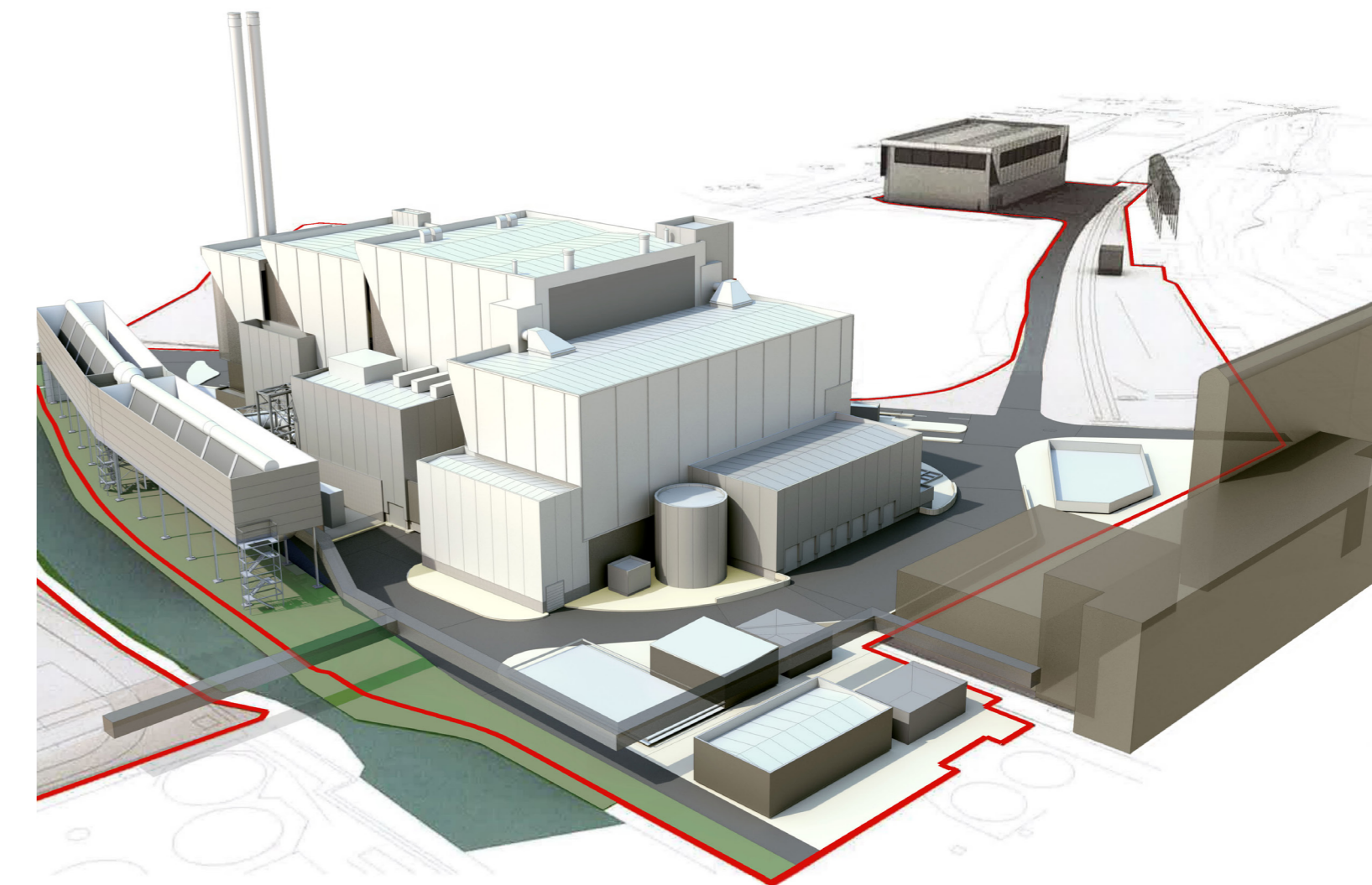

# Lostock Sustainable Energy Plant

The Lostock Sustainable Energy Plant (LSEP) is a £480m Energy from Waste facility located at the Lostock Works site near Northwich in Cheshire.

This nationally significant project is currently under construction following consent being granted in 2012 under Section 36 of the Electricity Act. LSEP Ltd acquired the project in 2017.

The facility has consent to generate up to 90MW of sustainable energy from residual waste remaining once recycling has taken place. We are proposing to apply to the Department for Business, Energy & Industrial Strategy (BEIS) to vary the Section 36 consent to enable us to deal with more waste while remaining within the currently approved power generation capacity.

If the plans are approved the facility would generate enough electricity to meet the requirements of up to 148,000 homes. It would also divert up to 728,000 tonnes of residual waste from landfill or prevent it from being exported overseas, with associated climate change benefits.

This newsletter provides information on our plans and how you can have your say. The consultation closes on 28th February 2021.

## Our Plans

The Lostock Sustainable Energy Plant is being built at the Lostock Works site on Griffiths Road near Northwich in Cheshire, on the site of a former coal-fired power station.

We are proposing to increase the amount of residual waste that the facility is permitted to take, meaning that we can divert an additional 128,000 tonnes of waste a year from landfill and generate even more sustainable energy. Our plans would not alter the currently approved buildings or structures, and we are not seeking to increase the limits on our environmental emissions, but would enable the use of the facility that is already being built to be maximised.

## Why Energy from Waste?

Many councils across the country – including Cheshire West and Chester – have declared ‘climate emergencies’ and adopted their own carbon reduction targets. The LSEP would result in a net reduction in greenhouse gas emissions, and therefore deliver climate change benefits, when compared with the alternative of the residual waste being landfilled and the equivalent power generation being provided by a Combined Cycle Gas Turbine (CCGT) power station.

The energy generated, enough to power a town three times the size of Northwich and Winsford, will replace energy generated from traditional gas- and coal-fired power stations. It will also prevent 728,000 tonnes of waste from potentially going to landfill – which releases greenhouse gases (methane and carbon dioxide) – or being exported abroad.

Using robust proven technology, the facility will accept residual waste for use as a fuel to generate electricity and heat. The process is regulated by the Environment Agency and will need to meet strict emissions limits during commissioning and operational phases.

We are actively looking at how heat from the facility could also be supplied directly to other local users in the area. There is also the potential for electricity to be provided via private wire connections to local businesses.

## The consenting process

We need to seek approval for the proposed changes to the planning consent through an application submitted to the Secretary of State for BEIS. We would then look to submit an application in summer 2021.

The increased throughput will result in a higher number of vehicle movements to and from the site, and more flexible hours for waste deliveries will be required. Therefore, as part of the application to vary the consent, we will undertake an environmental impact assessment which will look at the potential impact of the proposals on the environment. This will include updated transport and air quality assessments.

## Benefits of the LSEP scheme



Generate enough sustainable energy to power up to 148,000 homes or a town three times the size of Northwich and Winsford, displacing energy that would otherwise come from a fossil fuel power station.



Divert up to 728,000 tonnes of waste from landfill or export overseas every year.



Ongoing boost to the region's post COVID-recovery with a £480m investment and additional income for the Council with an estimated £2.6m in business rates.



Create around 50 high quality full-time operational jobs and up to 600 jobs during the three-year construction period.



Potential to heat local homes and industry through district heating and deliver electricity to local businesses through dedicated private wire connections.



Legacy of environmental community investment through the LSEP Community Fund.

## Questionnaire

Please complete this questionnaire, tear off the slip, fold in half, moisten and glue together. You can then just pop it in the post – there is no need to add a stamp!

Need more space? You can write to us at Freepost HAVE YOUR SAY (no stamp needed) or fill in the questionnaire online at [lostocksep.fccenvironment.co.uk](http://lostocksep.fccenvironment.co.uk)

All consultation responses must be submitted by 28th February 2021.

Q1. Do you agree that we should be looking at alternatives to landfill for the waste left after recycling?

Yes  No  Don't know

Please provide any comments here

Q2. What is your view on the plans to maximise the amount of waste that the consented facility can treat to increase the amount of low carbon energy generated and divert more waste from landfill?

Q3. What do you think about the potential for heat from the facility to be supplied to local homes and businesses?

Q4. Please use this space to make any general comments

## About you

Name \_\_\_\_\_ Address \_\_\_\_\_

Email \_\_\_\_\_ Phone \_\_\_\_\_

Age  Under 20  20-35  36-50  51-65  Over 65

This information is optional but will help us to analyse the information you have provided more effectively and enable us to keep you updated on the project in the future.

Would you like to be kept updated about the project?

Yes  No

Providing your contact details allows Font Communications Ltd, on behalf of LSEP Ltd, to assess the reach of the consultation and log responses. Should you select to be kept informed, your email address and telephone number will allow Font to keep you updated on plans for LSEP only. Copies of the feedback received may be made available, in due course, to the Department for Business, Energy & Industrial Strategy. We will, however, request that your personal details are not placed on the public record. Your personal details will be held securely by Font Communications Ltd and LSEP Ltd in accordance with the GDPR act 2018 and will not be passed to any additional third parties.

